

## Ethan Mobile Cart



kwalu®

# Ethan Collection

## Mobile Cart

Designed by Brian Graham, the collection seamlessly blends form and function, where minimalist design meets the complex needs of healthcare environments. Its soft edges and understated elegance create a serene, cohesive atmosphere that promotes healing and comfort. The collection offers practical storage solutions, including a wardrobe with a bench, a bench, several bedside tables—one featuring a mobile pouf—chests, and a mobile cart, all intuitively designed for ease of use. The durable Protea™ and Protea Fusion surfaces are engineered to withstand the rigors of healthcare settings, ensuring long-lasting performance.



Model: ETNMC02SS  
36W 21D 36H

## Features



### Durable Finish

Durable and resilient, Protea™ and Protea™ Fusion deliver the beauty of wood without any of the drawbacks. The finish is moisture impervious, easy to clean, and maintenance-free.



### Corian®/ Hanex®/ Krion® Top

Corian®/ Hanex®/ Krion® tops, with the Reverse Quarter Bevel, are available on all bedsides in the collection.

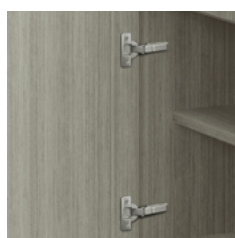

### Door Hinges

Features a 110° opening for easier access and smooth motion.



### Hardware

Choose from 3 hardware styles exclusive to the Ethan Collection.

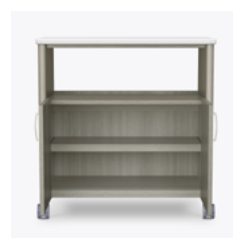

### Adjustable Shelf

Designed with a adjustable shelf for additional storage.

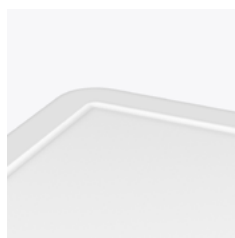

### Optional Solid Surface Spill Proof Edge

The spill resistant, slightly raised edge of this solid surface top keeps minor spills in place on the top.



### Optional Protea™ Fusion Top

Available with a top made of Protea™ Fusion. Spill proof capability not available with this top.

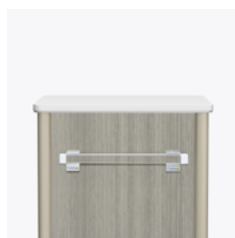

### Optional Accessory Rail System

A rail system, which keeps essential supplies within easy reach by attaching various accessories like baskets, bins and holders, is available and is optional.

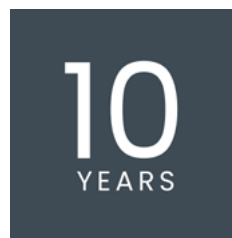

### 10 Year Warranty

We offer a 10 Year Performance Warranty on both construction and finish, so the product is guaranteed to stay looking like new for 10 years.

kwalu®

6160 Peachtree Dunwoody Rd. Building C, Atlanta, GA 30328  
1-877-MY-KWALU [kwalu.com](http://kwalu.com)

CGETNMC02F0924